

DC OUTPUT (max 600W) : 0 - 40 Amps
 0 - 1200 Volts



Presentation :

- Specifications:
 - 19 inch half-cabinet
 - Height : 2U
 - Width: 215 mm
 - Depth: 265 mm
- Minimum volume and weight for maximum capacity
- Switched mode technology
- Voltage and current controlled by PWM (Pulse Width Modulation)
- On request : programmable voltage/current: 0-10 V, isolated to 1500 Vrms
- Over-voltage protection (OVP) / Over-temperature protection (OTP)

Power : MX 600W Weight : 3 Kg	
Volts	Amps
0 - 15	0 - 40
0 - 30	0 - 20
0 - 50	0 - 12
0 - 75	0 - 8
0 - 100	0 - 6
0 - 150	0 - 4
0 - 180	0 - 3,2
0 - 250	0 - 2,4
0 - 350	0 - 1,6
0 - 750	0 - 0,8
0 - 1200	0 - 0,5



Descriptions :

- . Polycarbonate front panel
- . Two-colour On/Off LED: Off = red / On = green
- . Voltage and current adjustable using two 10-turn potentiometers (U-adj and I-adj)
- . Two modes of operation: constant current (CC) and constant voltage (CV) indicated by two LEDs
- . 2000-point digital displays (VOLTAGE/CURRENT)
- . Power output activated by pressing 'OUT'
- . Manual Voltage/Current preset (U/I set push button) shown on displays
- . Power input by standardised pluggable connector
- . Power outputs on insulated terminals or screw terminal block

Power : MX 600W	
Weight : 4 Kg	
AC Input	
Voltage	230 Vac Mono + 10% -15%
Frequency	47 / 63 Hz
Power factor	> 0,95
DC Output	
Power	600 W
Voltage	0 to 1200 V
Current	0 to 40 A
Mode of operation	CV/CC
Residual ripple	< 0,5% of the normal gauge
Accuracy (voltage and current)	< 0,2% of the normal gauge
Stability	< 0,2% of the normal gauge
Linearity	< 0,2% of the normal gauge
Distortion	< 0,5%
Environment	
Temperature	0 to +40°C (55°C derating)
Relative Humidity	85% without condensation
Cooling	Controlled air cooling
Dielectric Rigidity	1500 Vrms

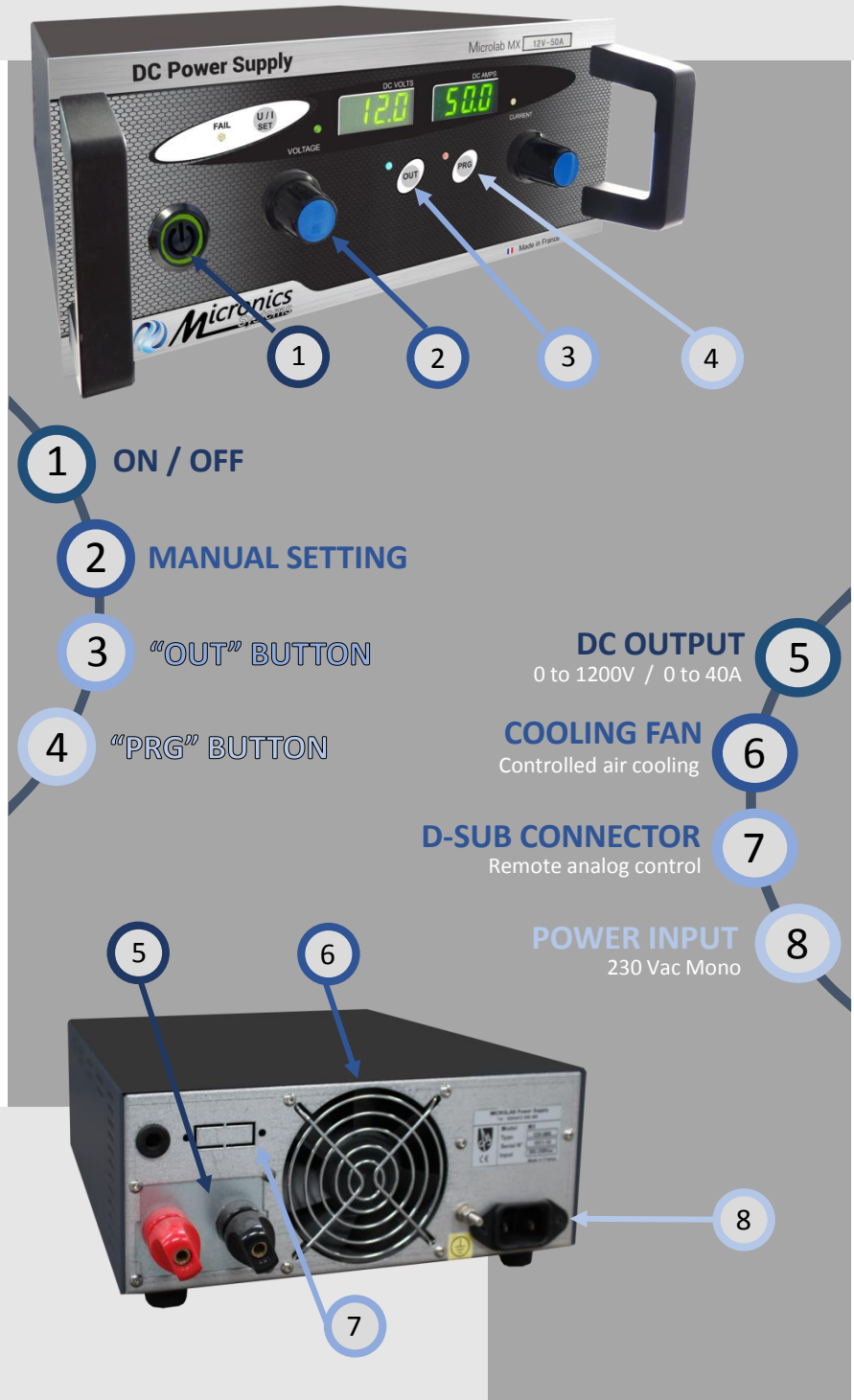

- 1 ON / OFF**
- 2 MANUAL SETTING**
- 3 "OUT" BUTTON**
- 4 "PRG" BUTTON**
- 5 DC OUTPUT**
0 to 1200V / 0 to 40A
- 6 COOLING FAN**
Controlled air cooling
- 7 D-SUB CONNECTOR**
Remote analog control
- 8 POWER INPUT**
230 Vac Mono

Customisation :

Digital control:

- 2-wire RS 485 / Ethernet / Wifi
- Profibus DP
- Standard : Schneider/ Siemens/Wago/Phoenix...

Analog control:

- U and I Inputs/Outputs
- 0-10V or 4-20 mA isolated 1500 Vrms

15-pin D-Sub connector for remote programming

Non-binding document, may be amended without notice.
 Ref: 140217 / MX 600W

